



**Central Avenue**

**Southend-on-Sea**

**£190,000**

Price Guide





# Central Avenue



## Description

\* 190,000 - 200,000 \* Bear Estate Agents are delighted to bring to the market this two bedroom first floor flat in a convenient location close to major railway links, local shop, good schools and the seafront. The property has a spacious living/dining room, modern fitted kitchen with access to a private garden and there are ample on street parking opportunities.

- First Floor Flat
- Private Rear Garden
- Double Glazing
- Spacious Living
- On-Street Parking Opportunities
- Two Bedrooms
- Close To Station
- Shower Room
- Gas Central Heating
- Close To All Local Amenities









Floor Plan

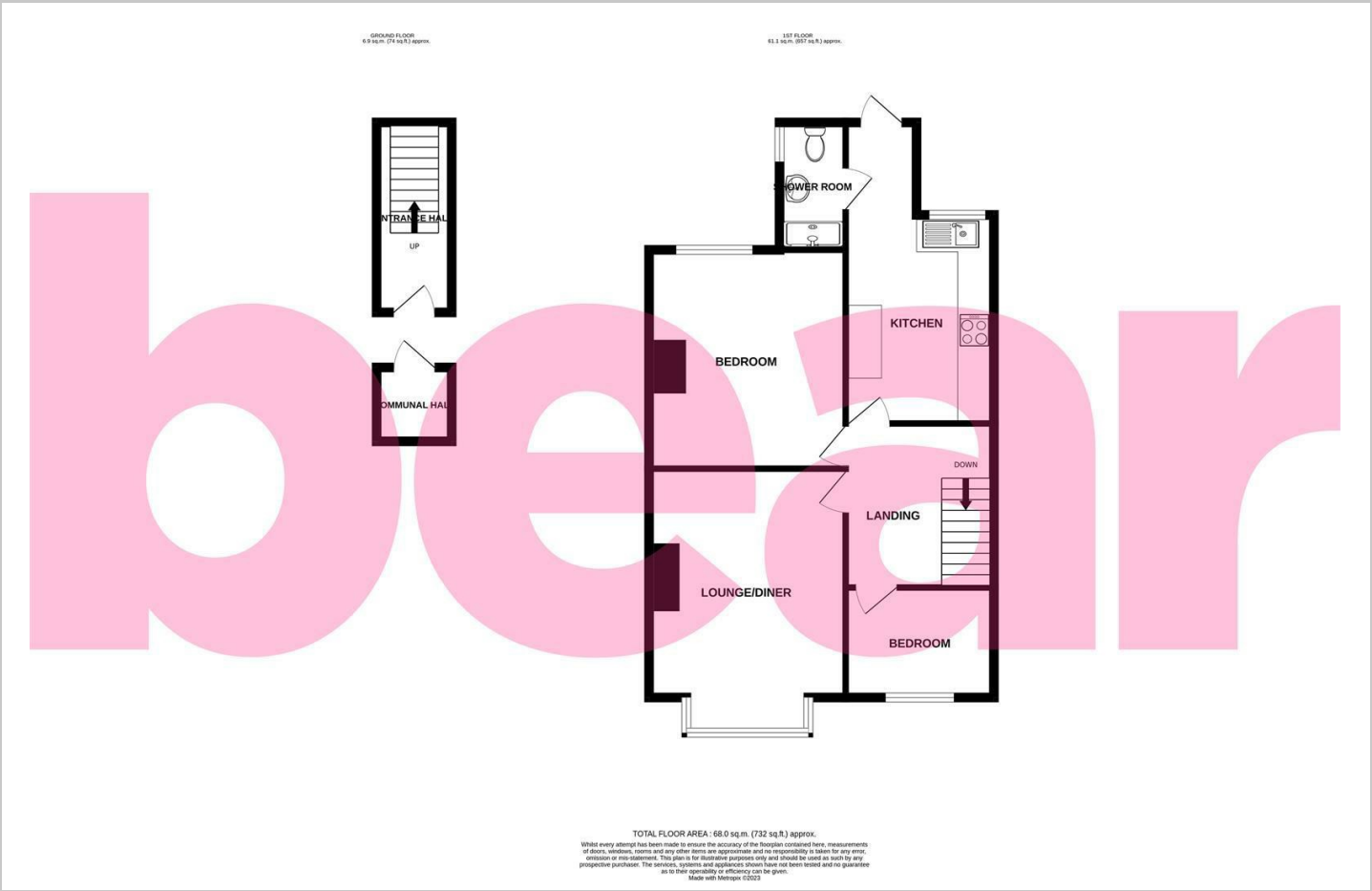

Area Map

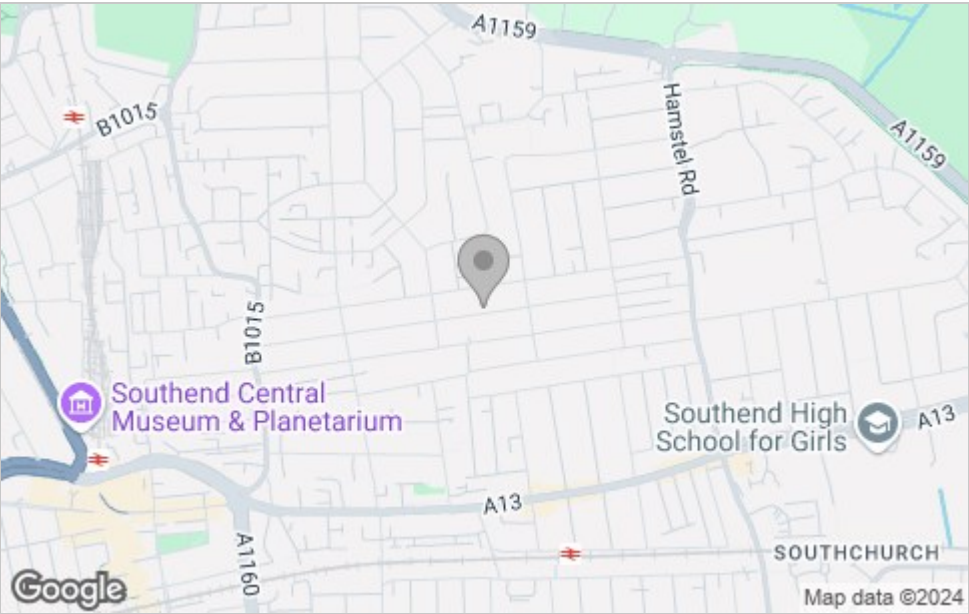

Viewing

Please contact our Southend-on-Sea Office on 01702 811211 if you wish to arrange a viewing appointment for this property or require further information.

Energy Efficiency Graph

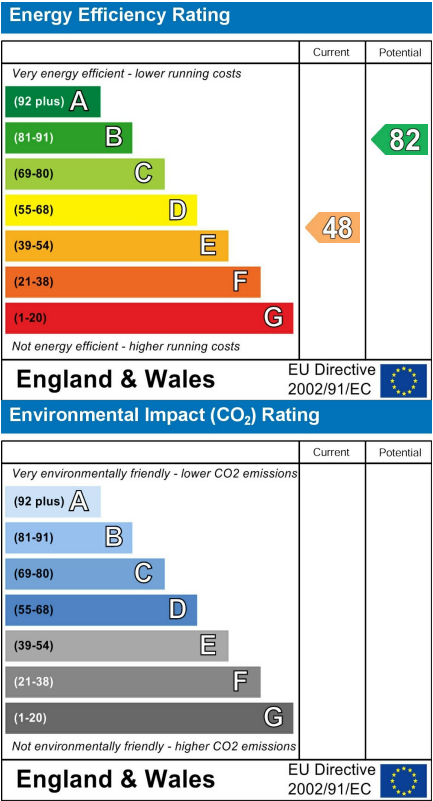

These particulars, whilst believed to be accurate are set out as a general outline only for guidance and do not constitute any part of an offer or contract. Intending purchasers should not rely on them as statements of representation of fact, but must satisfy themselves by inspection or otherwise as to their accuracy. No person in this firms employment has the authority to make or give any representation or warranty in respect of the property.